

## Thermodynamic DiscTrap

### • RATINGS

#### OPERATING PRESSURES AND TEMPERATURES

Arike series TDY131, Impulse Steam Traps will operate at all pressures from 4 to 600 psi at trap inlet, temperatures to 750 F. Sizes 1/2" and 3/4" in Series 31 and 131 traps, operate against back pressures at trap outlet to 70% of pressure at trap inlet (1" size to 60%).

Back pressure ratings are based on absolute pressure when Trap is discharging.

### • Tightening torques (Installation Instructions)

Trap Size	Parte	N.m
1/2"	Trap Bonnet	61-68
	Strainer Bonnet	129-136
	Seat	129-136
3/4"	Trap Bonnet	75-82
	Strainer Bonnet	156-163
	Seat	183-190
1"	Trap Bonnet	109-115
	Strainer Bonnet	183-190
	Seat	210-217

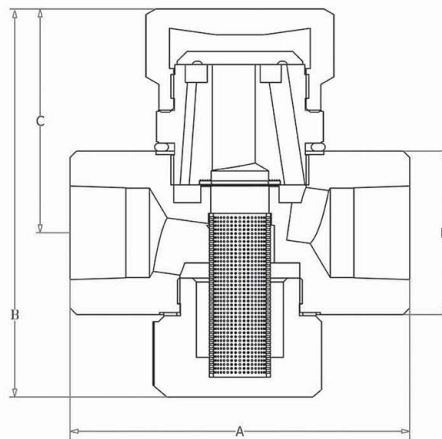
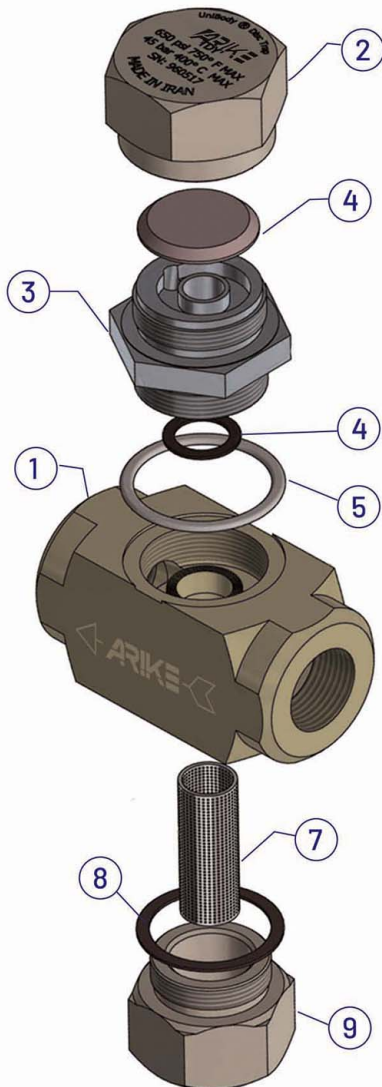

### • Parts/ Material

Item	Part	Material
1	Body	400 Series S/S
2	Trap bonnet	400 Series S/S
3	Seat	400 Series S/S
4	Disc	400 Series S/S
5	Body Gasket	Graphite /Stainless steel
6	Seat Gasket	MONEL
7	Screen	300 Series S/S
8	Strainer Gasket	Graphite /Stainless steel
9	Strainer bonnet	400 Series S/S

### • Features

- 1-Inline Replaceable valve module.
- 2- Easy to check cyclic operation
- 3- Built - in screen for trouble- free service.
- 4- Self-draining (vertically mounted)
- 5- Hardened stainless steel working surfaces.
- 6- Hardened, rugged stainless steel internals
- 7- Unaffected by water hammer

### • Trap Sizing

Determine trap capacity required by multiplying the maximum calculated condensate load by a safety load Factor (of 2). Then select the trap having this rated capacity for the gauge pressure (psi) at the trap inlet. See Capacity Table.

### • TDG 50 -Thermodynamic Steam Trap

Trap Size	Dimensions. [mm]					Weight(kg)
In	DN	A	B	C	D	TDY131
1/2"	15	73	82	46	35	1,1
3/4"	20	85	105	55	42	1,5
1"	25	98	120	67	51	2,3

### • Spare Parts

Item	
Replaceable Module	2,3,4,5,6
Screen	10
Cap Gasket	11

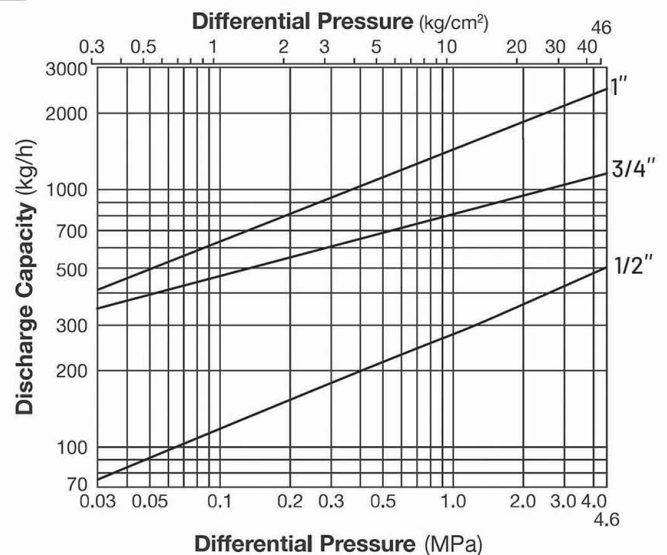

1. Differential pressure is the difference between the inlet and outlet pressure of the trap.
2. Recommended Safety Factor: at least 1.5